

**North Lawndale STEAM
Partnership Academy**
A Community-Driven Proposal

Community
Meeting

Meeting Norms

- Respect others opinions
- Speak your truth
- “Two before me”
- Expect and accept non-closure

Agenda



- Welcome!
- Purpose & Objectives
- Presentation from the North Lawndale Community Coordinating Council Education Committee/ North Lawndale CAC
- Community Feedback and Discussion
- Next Steps



SUCCESS STARTS HERE

CHICAGO PUBLIC SCHOOLS
FIVE-YEAR VISION

Objectives

- **Share information** regarding the community-led proposal for the North Lawndale community
- **Collect your feedback** about this specific school model and its impact on your school community

STEAM

Science * Technology

Engineering * Arts * Mathematics



North Lawndale Community Action Council and North Lawndale Community Coordinating Council Educational Committee

Our VISION is to ensure that every student who attends school in North Lawndale receives a rigorous and high-quality education.

Today in North Lawndale

Due to student demographic shifts in North Lawndale, many schools don't have enough resources to offer students adequate programming

58 years since a traditional elementary Chicago Public School was built.

Many families are choosing to go to schools in other communities across the city seeking quality options.

The North Lawndale Community desired that the proposed STEAM Partnership Academy provide:

- A state-of-the-art-facility and equipment for an enrollment of 700 students.
- African American History, North Lawndale History and Social Justice will be taught and learned Pk-8th grade.
- A focus on teaching and learning with an integrated technology- infused curriculum.
- Diverse learner supports and services.
- A school where parents are welcomed and supported.
- Social emotional learning services.
- Restorative justice practices.
- A safe and conducive learning environment.
- Sustainable resources for the STEAM Partnership Academy.
- STEAM Programs to prepare our students for success in high school and a career pathway for the future.



Proposed North Lawndale STEAM Partnership Academy

- The new proposed STEAM Partnership Academy will be a traditional Chicago Public School for Pre-Kindergarten-8th Grade Students.
- The proposal recommends that Crown Fine Arts Academy and Lawndale Community Academy will be consolidated into Sumner Math and Science Academy.
- Sumner Math and Science Academy would retain its full staff which includes the administration, teachers and support personnel.
- The proposal recommends that Crown and Lawndale staff would be given priority to positions within the STEAM partnership Academy.
- The proposal recommends that the new proposed STEAM Partnership Academy be centrally located in the North Lawndale Community.
- The proposal recommends replacing the east building of the Lawndale Community Academy with a new State- of -the –Art- Facility.

School Safety and Transportation

The proposal recommends that Crown, Lawndale, and Sumner are included in:

- Chicago Public Schools Safe Passage Program designed to increase student's safety.**
- Chicago Public Schools Transportation Program.**
- Developing a relationship with Chicago Police Department to monitor hot spots before and after school.**

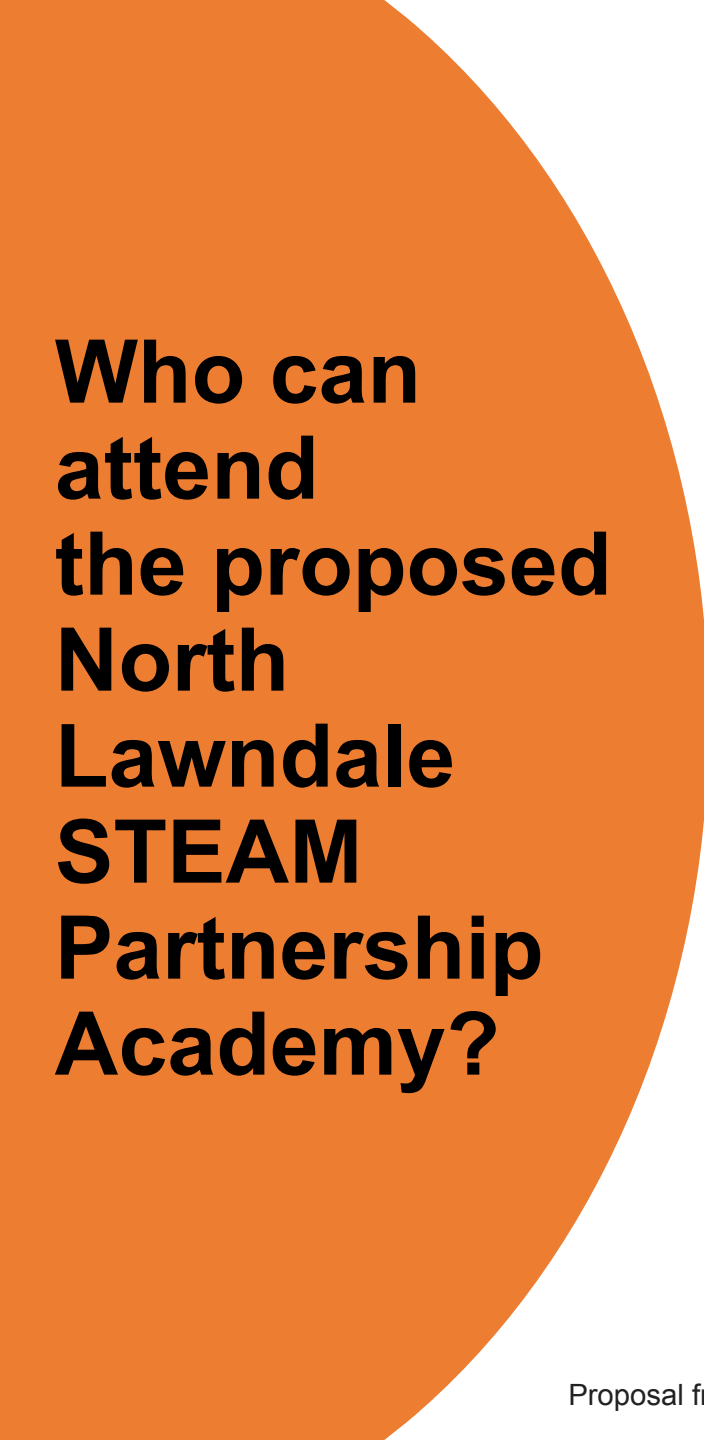
A large orange circle is positioned on the left side of the slide, partially cut off by the edge.

Who can attend the proposed North Lawndale STEAM Partnership Academy?

This proposal is to support all Pre-Kindergarten-8th grade students enrolled in or that live within the attendance boundaries of Crown, Lawndale, and Sumner Elementary Schools. All these students would have a seat in the new STEAM Partnership Academy.

Proposed Images

for the North Lawndale STEAM
Partnership Academy

The proposed North Lawndale STEAM Partnership Academy



Sample rendering provided by NLCAC/NLCCC to visualize proposed North Lawndale STEAM Partnership Academy.

The proposed North Lawndale STEAM Partnership Academy



Sample rendering provided by NLCAC/NLCCC to visualize proposed North Lawndale STEAM Partnership Academy.

Sample lobby provided by NLCCC/ North Lawndale CAC

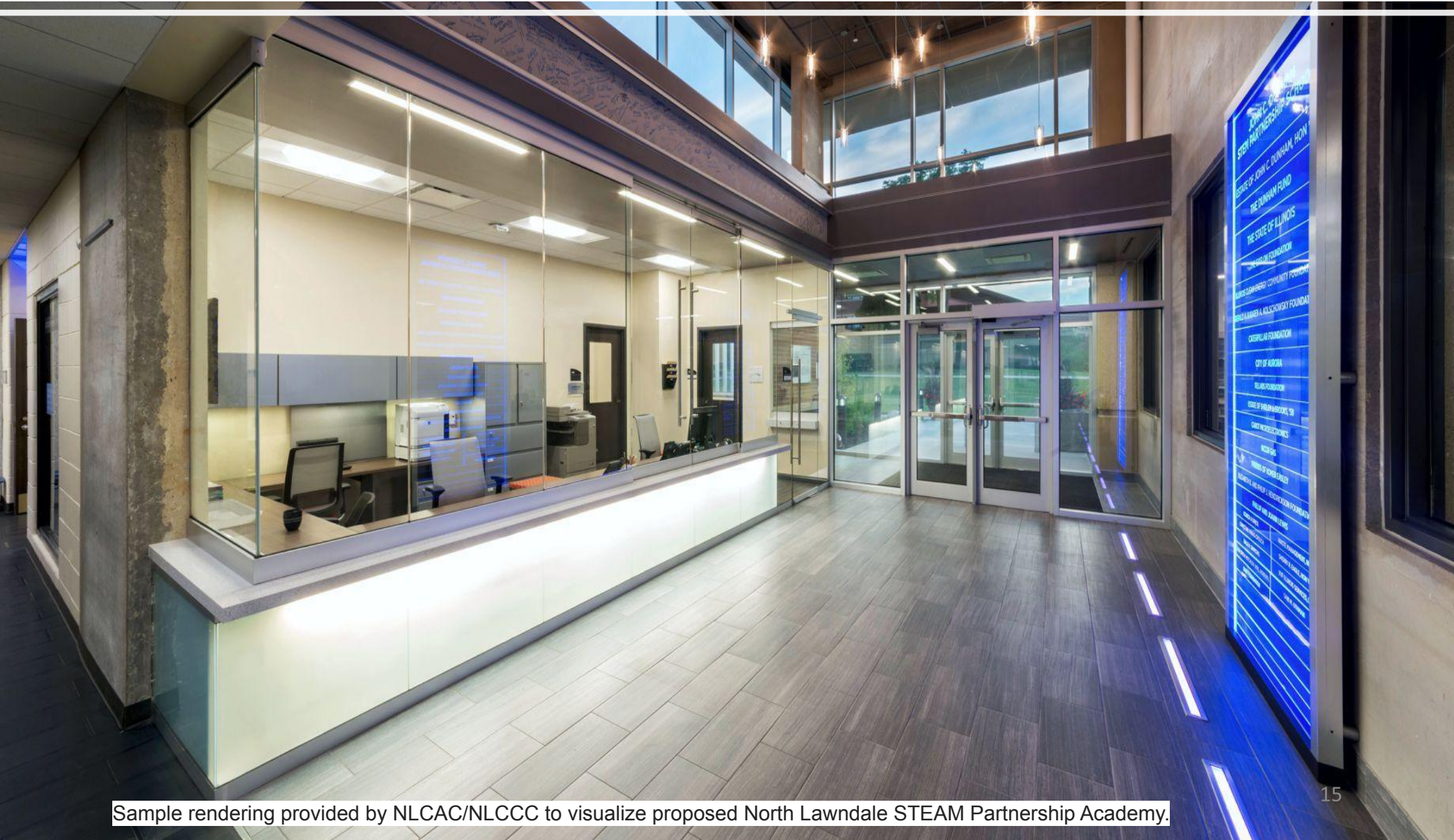

Sample Classroom provided by NLCCC/ North Lawndale CAC



Sample Classrooms and Hallway provided by NLCCC/ North Lawndale CAC



Sample rendering provided by NLCAC/NLCCC to visualize proposed North Lawndale STEAM Partnership Academy.

Sample Science Lab provided by NLCCC/ North Lawndale CAC

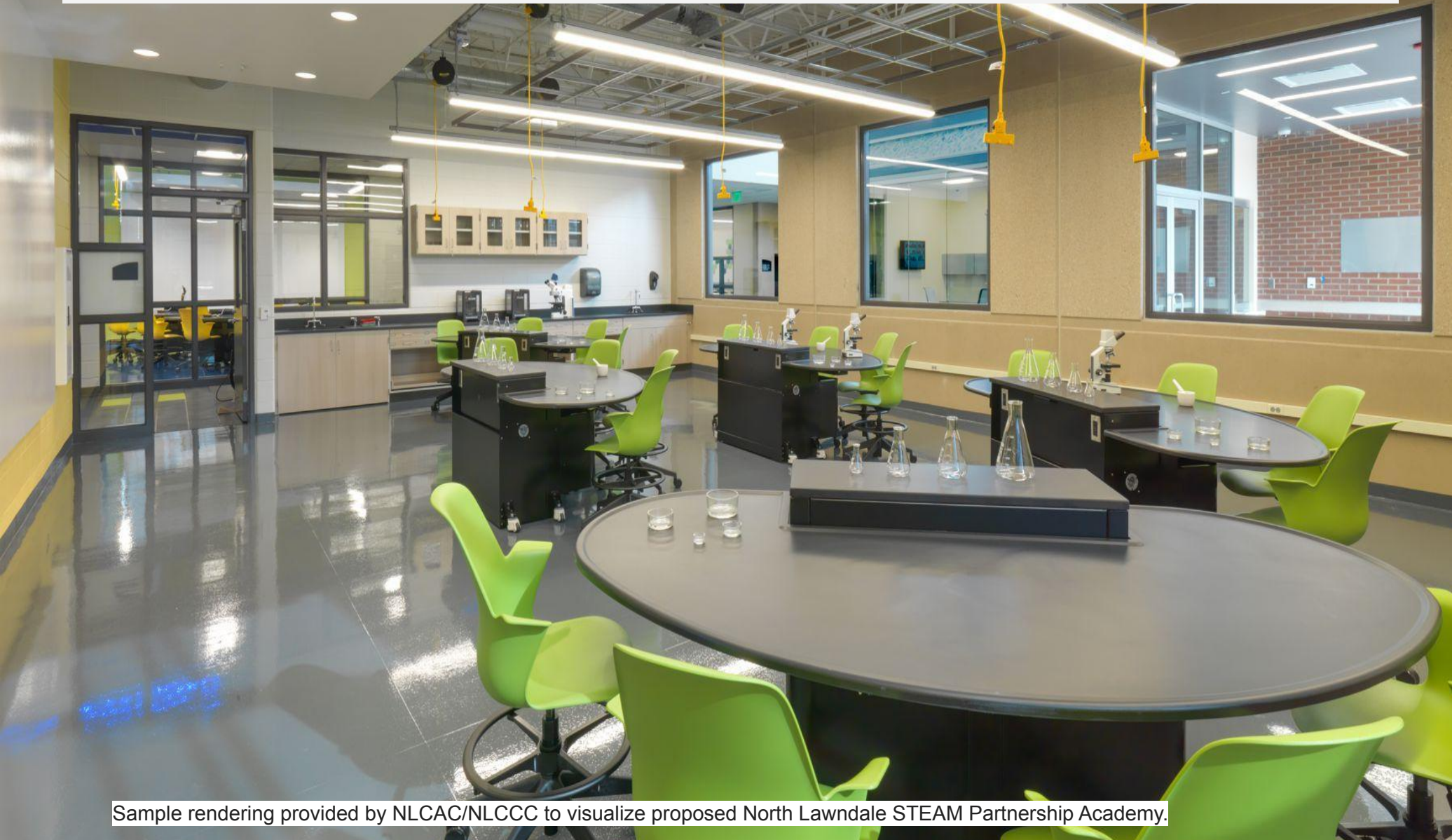

Sample rendering provided by NLCAC/NLCCC to visualize proposed North Lawndale STEAM Partnership Academy.

Sample Cafeteria provided by NLCCC/ North Lawndale CAC



Sample rendering provided by NLCAC/NLCCC to visualize proposed North Lawndale STEAM Partnership Academy.

Sample Gymnasium provided by NLCCC/ North Lawndale CAC



Sample rendering provided by NLCAC/NLCCC to visualize proposed North Lawndale STEAM Partnership Academy.



Sample
Fitness Room
provided by
NLCCC/
North
Lawndale
CAC

This is a community led initiative to provide greater educational and learning opportunities, options and enrichments activities for the students of North Lawndale

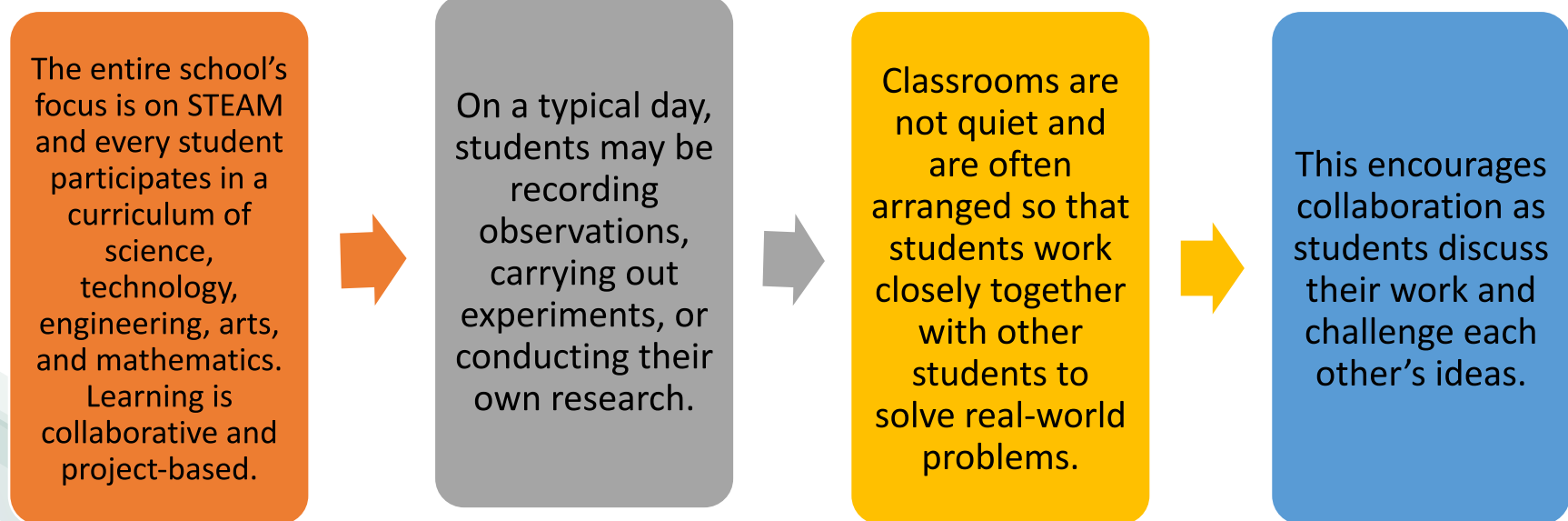

Student Learning Opportunities

	Students will learn to:
Investigate	investigate, analyze, solve problems and work in teams as they acquire, integrate apply new knowledge
Apply	apply critical thinking skills throughout the curriculum
Create	create digital literacy solutions
Use	use computers and other technology skills
Incorporate	incorporate performing and visual arts in all content learning topics
Connect	connect STEAM learning to a career pathway
Work and Engage	work and engage with corporate, not-for-profit and university professors in problem solving

An abstract composition of various geometric shapes. In the top left, a green right-angled triangle points towards the top right. To its right is a blue semi-circle. Below the green triangle is a blue circle. In the center is a large orange semi-circle. To the right of the orange semi-circle are two vertical yellow bars. In the bottom left is a large orange circle. Above it are two yellow curved bars. In the bottom right is a green square frame.

Steam Careers for the 21st Century

- [Computer and Information Systems Manager](#)
- [Computer Systems Analyst](#)
- [Chemical Engineer](#)
- [Software Developer](#)
- [Mechanical Engineer](#)
- [Biomedical Engineer](#)
- [Website App Developer](#)

- [Financial Manager](#)
- [Robotics Engineer](#)
- [Mathematician](#)
- [Aerospace Engineer:](#)
- [Engineering Manager](#)
- [Statistician](#)
- [Graphic designer](#)
- [Orthopedic Technologist](#)

The proposed
**NORTH LAWNSDALE
STEAM PARTNERSHIP
ACADEMY
INTEGRATED
TECHNOLOGY-INFUSED
CURRICULUM**

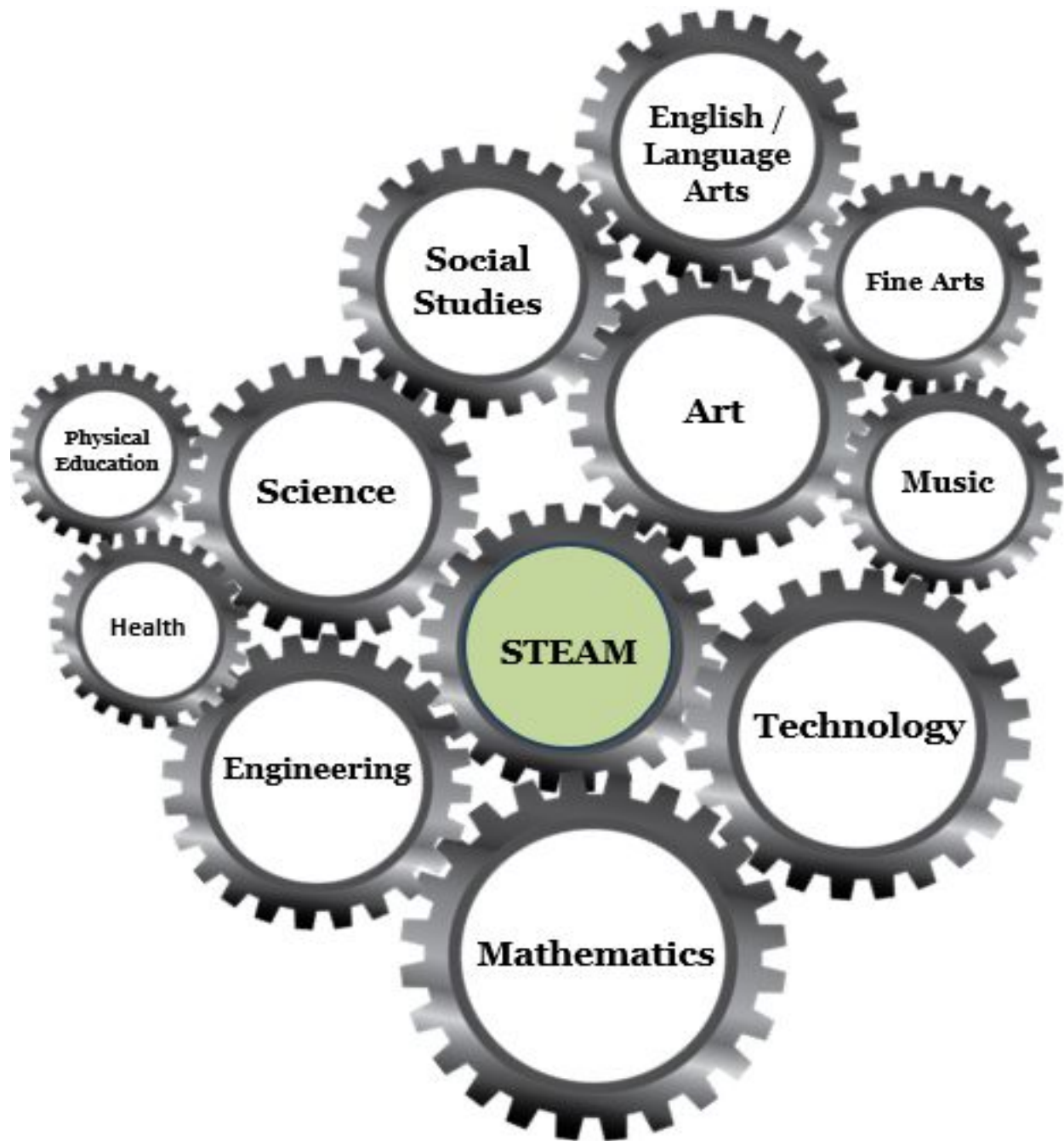

Partners for the proposed North Lawndale STEAM Partnership Academy

Corporate Partners/Business Partners/ Foundations

- BMO Financial*
- Cabot Microelectronics*
- Caterpillar
- Chicago Mercantile Exchange*
- Cinespace*
- Cordogan Clark Associates
- Exelon Foundation*
- McGowan Family Fund*
- F.H. Pashen
- People's Gas*
- Steans Family Foundation*

Not- For- Profit Partners/Government

- Black Ensemble Theater
- Carole Robertson Center
- Chicago Lawndale AMACHI Mentoring Program
- Chicago Children's Museum
- Chicago Public Schools
- Chicago Shakespeare Theater
- Fermi National Laboratory
- Juvenile Protection Association
- Local Initiatives Support Corporation (LISC)
- Museum of Science and Industry
- Sinai Health System
- Shedd Aquarium

**Fiscal Planning Partners*

A decorative graphic consisting of a grid of blue dots on the left side of the slide, transitioning into a solid blue horizontal bar at the bottom.

Partners for the proposed North Lawndale STEAM Partnership Academy

University Partners

- Aurora University
- University of Illinois at Chicago

North Lawndale Community Partners

- North Lawndale Community Action Council
- North Lawndale Community Coordinating Council

Parent Input Survey

When developing the *Parent Engagement Implementation Plan*, more than 160 surveys were completed by parents. Parents requested the following programs:

Provide
Continuing
Education
Opportunities
for Parents

Computer
Training
Classes

Job Training

Parenting
Classes

Cooking and
Nutrition
Classes

Exercise and
Fitness Classes

Saturday
Family
Activities

GED
Preparation

Financial
Literacy Classes

Trauma
Counseling

Childcare and
Transportation
to support
access to the
Parent Center



COMMUNITY FEEDBACK



Next Steps

We hope this discussion has been engaging, and look forward to hearing more of your thoughts and ideas! Here are some **potential immediate next steps**:

- **Fill out the post-event survey:** tinyurl.com/nlsteam-survey
- **Share what you heard today:** We want this information to reach as many people as possible. Tell your LSC members, other parents and neighbors about it.
- **Learn more about the proposal:** To learn more about the proposal or to be a parent ambassador, please reach out directly to the NLCCC/North Lawndale CAC at 312-857-4480 or at northlawndalesteamacademy@gmail.com

Thank you for your input and engagement!